

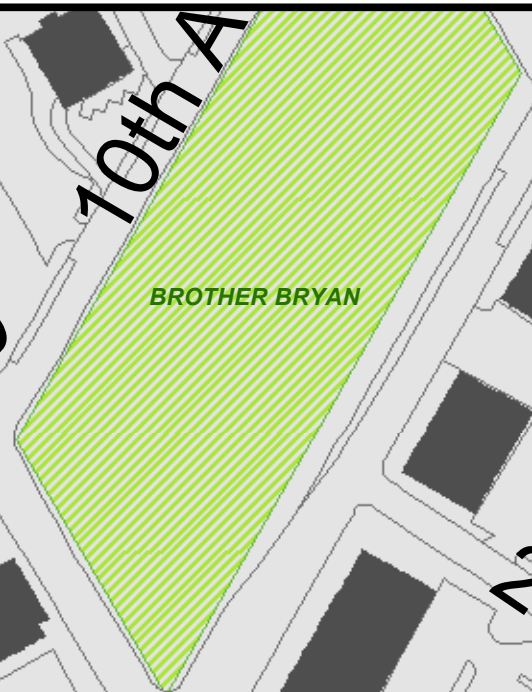

**Five Points South**  
Commercial Revitalization District



BROTHER BRYAN

- Railroad
- Edge of Paving
- Landmarks
- Park
- CRD: Five Points South
- City of Birmingham

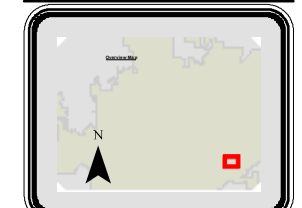

This map was prepared for public representation and should not be used for legal purposes. The use of this map is subject to the terms and conditions of the City of Birmingham. All rights reserved. © 2014 City of Birmingham. All rights reserved.

Birmingham Online Mapping  
Internet (Public Access)  
<http://gisweb.birminghamal.gov/>

J:\CRD\CRD\MAPS\MXD\FivePointsSouth.mxd

